

AMBER WERCHON

PROPERTY · PEOPLE



337 Bradman Avenue Maroochydore QLD

4 2 1

With only a handful of homes left along Bradman Avenue, this offering of 774m² land parcel - zoned medium density residential, and backing onto expansive sporting fields, boasting a perfect prized northerly aspect with river and parkland views, and located diagonally opposite boat ramp; is a blue-chip slice of premium Sunshine Coast property!

There is an existing lowset, comfortable liveable dwellings onsite, currently tenanted, that can be retained for income stream by land-banker, and the zoning also offers the clear possibility of redevelopment, subject to council approvals. The lifestyle-driven buyer who enjoys boating and fishing, could knock down existing dwellings and build a magnificent riverfront home on a huge double block, with no fear of overcapitalising!

The location is lifestyle-nirvana - directly opposite a leafy

Price : Contact Agent
Land Size : 774 sqm
View : <https://www.amberwerchon.com.au/803332>
2



Daniel Mendes
07 5430 0888



Amber Werchon
07 5430 0888

<https://www.amberwerchon.com.au>

HOUSE SIZE: 190m²
LAND SIZE: 774m²

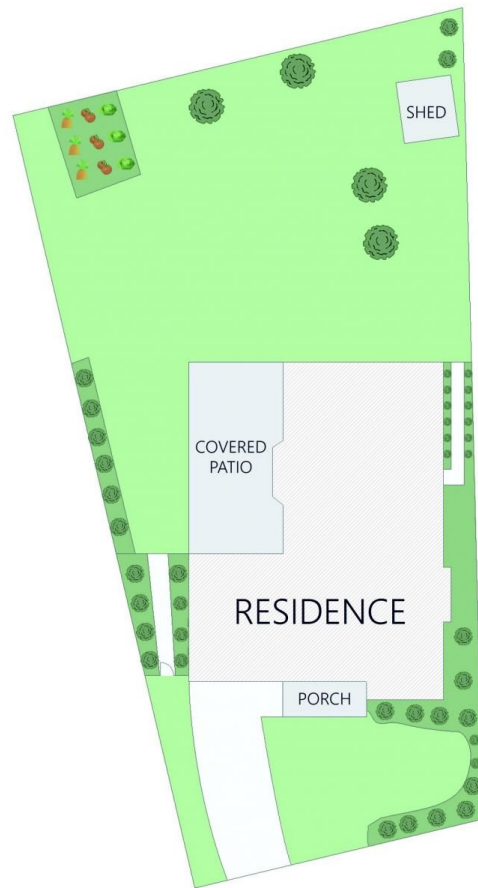
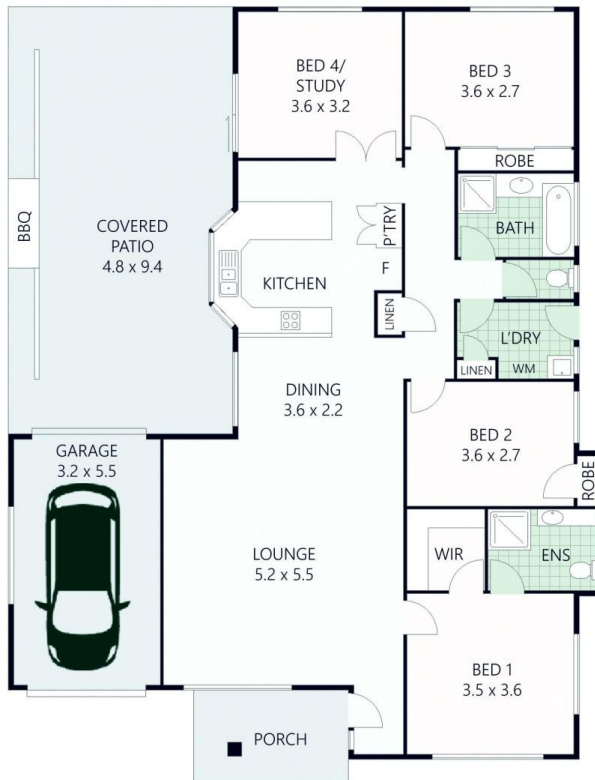

ARTIST'S IMPRESSION ONLY: While every attempt has been made to ensure the accuracy of this floor plan's areas and measurements of doors, windows, rooms and all other items are approximate and no responsibility is taken for any error, omission, or mis-statement. This plan is for illustrative purposes only and should only be used as such by any prospective purchaser. Floor plan by: www.realestatefloorplans.com.au

