

# AMBER WERCHON

PROPERTY · PEOPLE



## 117 Nicklin Road Palmwoods QLD

3 1 5

Amber Werchon Property presents to the market, 117 Nicklin Road, Palmwoods: this fully useable four-hectare property on one of the most sort after roads in Palmwoods and is on the outskirts of the village comprises a post-war home ready for renovation, large sheds/studio, and spring-fed dam; offering a clear opportunity to value-add as well as create possible income stream.

The home itself circa 1950, comprises porch at entry, foyer/study nook, three bedrooms, one bathroom, separate toilet, formal lounge, large eat-in kitchen, and laundry. Brush box timber floors and original casement windows are some of the period features from its era that enhance charm, and in addition there are ceiling fans, stainless steel appliances including dishwasher, and separate shower and

**Type** : Acreage/Semi-Rural  
**Price** : Contact Agent  
**Land Size** : 9.88 Acres  
**View** : <https://www.amberwerchon.com.au/8145112>

[For full version visit the website](https://www.amberwerchon.com.au)





**Dan Lal**  
07 5430 0888

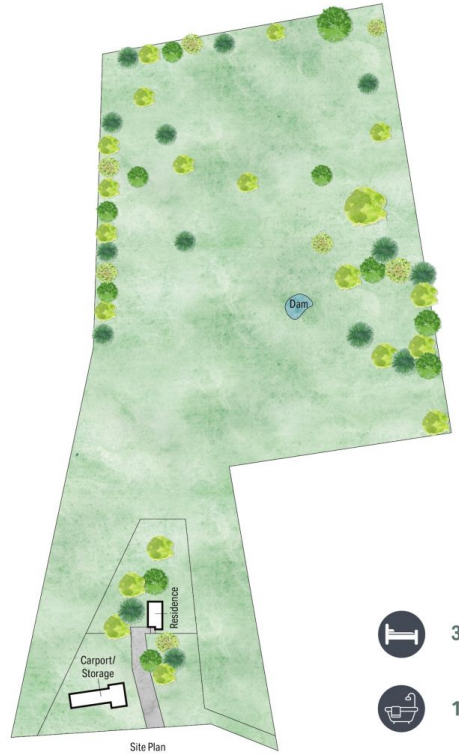
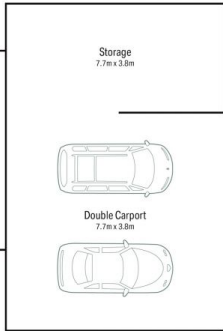

**Kerry-Anne Crowley**  
07 5430 0888

<https://www.amberwerchon.com.au>



-  3
-  1
-  6

# 117 Nicklin Road, Palmwoods

Whilst [bwrm.com.au](http://bwrm.com.au) has made every attempt to ensure the accuracy of the floor plan contained here, measurements are approximate and no responsibility is taken for any error, omission, or mis-statement. This plan is for illustrative purposes only.



INTERNAL : 98m<sup>2</sup>  
 LAND : 4Ha (9.88 Acres)

