

AMBER WERCHON

PROPERTY · PEOPLE



11 George Street Nambour QLD

4 2 2

Amber Werchon Property proudly presents 11 George Street, Nambour; the iconic "Elizabeth Lodge," a charming Queenslander that is truly one of a kind.

Once home to Nambour's first Mayor, this beautifully restored Queenslander seamlessly merges the character of its 1920s origins with modern comforts, offering an exceptional lifestyle in one of the Sunshine Coast's most promising suburbs.

As soon as you step inside this lovingly restored residence, you'll feel as though part of you has stepped back in time. Solid timber floors, leadlight casement windows, modest chandeliers, and vintage door handles set the stage, while soaring 3.3-metre high ceilings and Victorian-era details

[For full version visit the website](https://www.amberwerchon.com.au)

Type : House
Price : Contact Agent
Land Size : 478 sqm
View : <https://www.amberwerchon.com.au/8156607>



Lucy Werchon
07 5430 0888



Naj Elsayed
07 5430 0888

<https://www.amberwerchon.com.au>

AMBER WERCHON

PROPERTY • PEOPLE

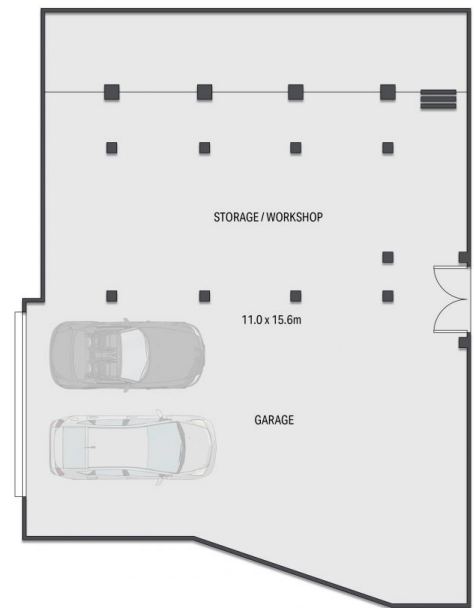

GROUND FLOOR PLAN ON SITE

This floor plan including furniture, fixture measurements and dimensions are approximate and for illustrative purposes only. BoxBrownie.com gives no guarantee, warranty or representation as to the accuracy and layout. All enquiries must be directed to the agent, vendor or party representing this floor plan.

11 George Street, Nambour